

Freezer Info Sheet



Table of Contents

[Overview](#)

[Frequently Asked Questions](#)

[How do I turn the freezer on/off?](#)

[How do I change the temperature?](#)

[What temperature should I set it to?](#)

[What is this switch?](#)

[Do you have any tips for scooping water ice?](#)

[How many 2.5 gallon tubs of water ice does the freezer hold?](#)

[What are the physical specifications of the freezer?](#)

[What are the electrical specifications of the freezer?](#)

[Can I use an extension cord with my freezer?](#)

[What type of refrigerant does the freezer use?](#)

[Does it have wheels?](#)

[Where is the dip well?](#)

[Do the glass doors lock?](#)

[Is a sneeze guard available for this freezer?](#)

[Who should I contact for issues or repairs?](#)

Overview

The PWI HB-14LD flat-top display freezer features interior LED lighting, heat reflective glass-sliding lids and manual defrost.

It includes a drain and plug, casters, cord and plug, has a white painted steel exterior and a white painted galvanized steel interior.

It includes a full-color Philadelphia Water Ice front panel wrap to attract customers and maximize sales.

It features a wide-ranging internal thermostat with temperature adjustable from -10°F to $+40^{\circ}\text{F}$.



Frequently Asked Questions

How do I turn the freezer on/off?

When you plug the freezer into the electrical outlet, it turns on. If you unplug it, it turns off. An alternative way to turn the freezer off is to turn the copper screw of the temperature gauge down below **1**, at which point you will hear it click off.

How do I change the temperature?

Facing the front of the freezer, on the right side, you will find the thermostat.

There is no temperature knob. To change the temperature, you must use a flat-head screwdriver to turn the copper screw:

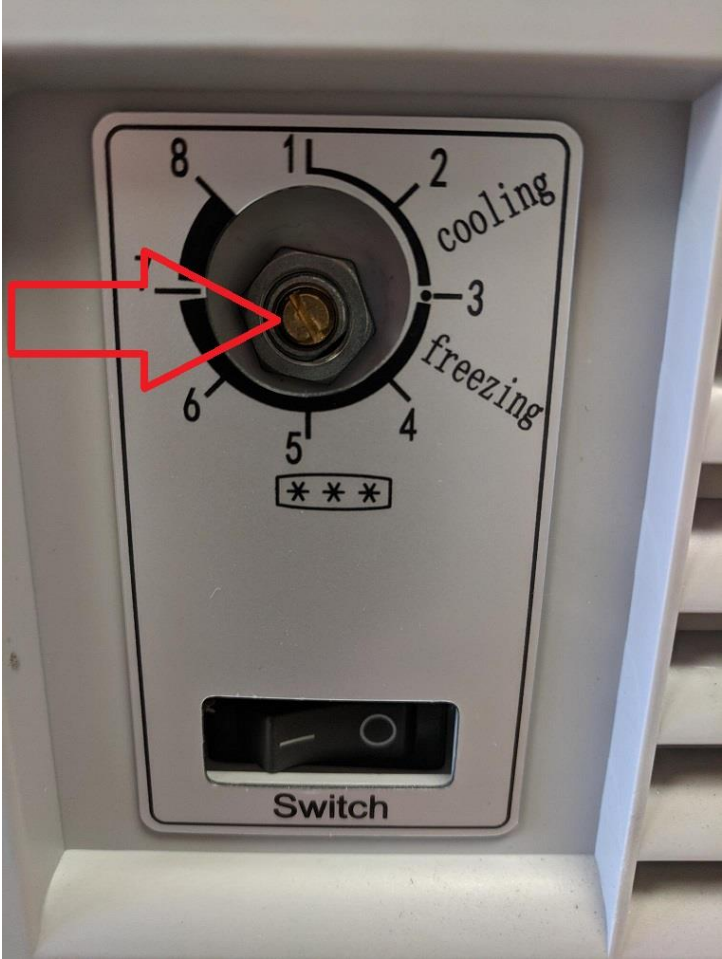



1 is warmest and **8** is coldest. The higher the number, the colder.

What temperature should I set it to?

4.5 (+18° F) For high volume stores. This is the ideal temperature for scooping water ice.

5.5 (+13° F) For low volume stores.

6 (0° F) Store at 0° or colder for long-term storage of water ice. Shelf-life is 1 year.

What is this switch?

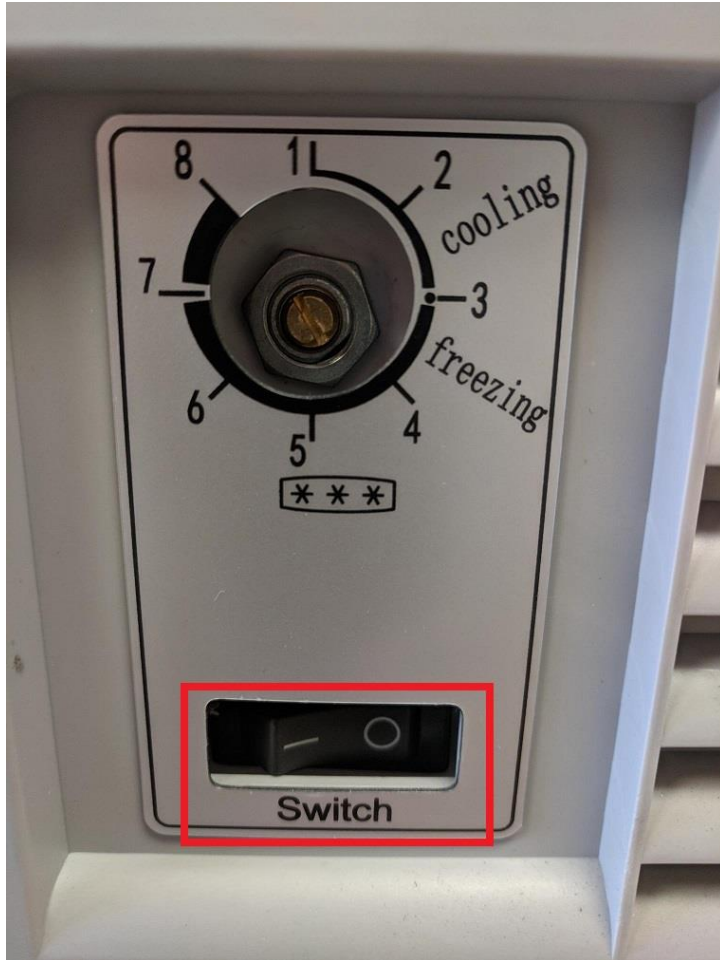

This switch turns the internal **light** on/off. It does **NOT** turn the machine on/off!

Do you have any tips for scooping water ice?

Keep the tub level and flat when scooping. Do not dig holes. We recommend using a #12 or #16 mechanical scooper for dipping.

How many 2.5 gallon tubs of water ice does the freezer hold?

14 tubs. 6 on the bottom and 8 on top.

What are the physical specifications of the freezer?

Size (L x D x H): 51.5" x 27.25" x 32.75"

Shipping Weight: 185 lbs.

What are the electrical specifications of the freezer?

Voltage/Hz/Phase: 115/60/1

Rated Power: 210W

Running Current Input: 2.0A

Can I use an extension cord with my freezer?

Do not use an extension cord with this freezer. It is not recommended due to safety concerns.

What type of refrigerant does the freezer use?

Please refer to the sticker on the back of the freezer for the refrigerant type.

Does it have wheels?

Yes, it has wheels.

Where is the dip well?

The freezer does not include a dip well. Please contact the manufacturer if you are interested in ordering one. Their phone number can be found on the sticker on the back of the freezer.

Do the glass doors lock?

Yes, there is a keyhole to lock the top sliding glass doors. Please contact us if you would like a key.

Is a sneeze guard available for this freezer?

Yes. A sneeze guard is available for purchase from the manufacturer.

Who should I contact for issues or repairs?

Please call Excellence Industries directly at: 800-441-4014. Before contacting them, please have your freezer's model number and serial number ready. These numbers can be found on the sticker on the back of your freezer.